

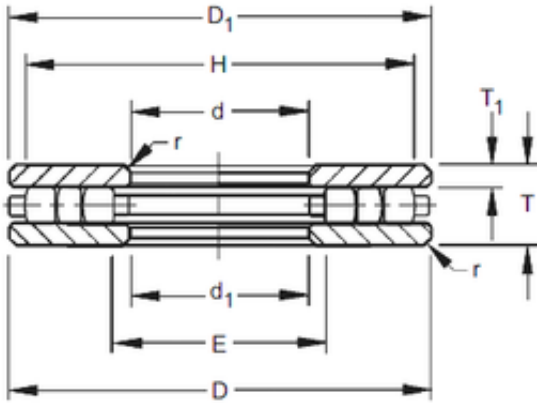

30TP109 Timken Tapered Roller Bearings

Bearing No. 30TP109



Size	76.2x228.6x34.925 mm
Bore Diameter	76,2 mm
Outer Diameter	228,6 mm
Width	34,925 mm
d	76,2 mm
D	228,6 mm
T	34,925 mm
r max	1,6 mm
T1	9,52 mm
d1	77,79 mm
D1	227,01 mm
E	92,1 mm
H	212,7 mm

30TP109 Bearing 2D drawings and 3D CAD models